

Why Rent the IGP Institute?

The IGP Institute Conference Center is available to host workshops, conferences or other meetings for outside organizations. The facility includes a conference room, atrium, multipurpose room, auditorium, grain grading classroom, and a dining and outdoor lounge area.

The building is available to host dinners and receptions as well as educational workshops. The institute does have a list of preferred caterers.

If you're interested in using the facility for your next event, contact:

Lisa Long

Events Coordinator

Phone: 785-532-7160

Fax: 785-532-6080

Email: igp@ksu.edu

A/V capabilities include: built in projector, computer with internet, DVD, video, overhead projector and touch screens in some rooms.



IGP Institute

Department of Grain Science and Industry

Kansas State University

1980 Kimball Avenue

102 IGP Institute Conference Center

Manhattan, KS 66506 USA

Phone: 785-532-4070

Fax: 785-532-6080

Email: igp@ksu.edu

For more information visit:

www.grains.ksu.edu/igp

Our Mission

To provide innovative and relevant education and technical programs to enhance the market preference, consumption and utilization of U.S. cereal grains, oilseeds and their value-added products for the global grain industry.

Kansas State University Notice of Nondiscrimination

Kansas State University is committed to nondiscrimination on the basis of race, color, ethnic or national origin, sex, sexual orientation, gender identity, religion, age, ancestry, disability, genetic information, military status, veteran status, or other non-merit reasons, in admissions, educational programs or activities and employment, including employment of disabled veterans and veterans of the Vietnam Era, as required by applicable laws and regulations. Responsibility for coordination of compliance efforts and receipt of inquiries concerning Title VI of the Civil Rights Act of 1964, Title IX of the Education Amendments of 1972, Section 504 of the Rehabilitation Act of 1973, the Age Discrimination Act of 1975, and the Americans With Disabilities Act Amendments Act of 2008, has been delegated to the Director of Institutional Equity, Kansas State University, 103 Edwards Hall, Manhattan, KS 66506-4801, (Phone) 785-532-6220; (TTY) 785-532-4807.

Revised August 14, 2014.



IGP Institute



IGP Institute Conference Center



Rental Information

**KANSAS STATE
UNIVERSITY**

Atrium

**Cost:**

\$125 without meal

\$200 with meal and/or A/V

Capacity:

200 people

meal price not included

Dining Room

**Cost:**

\$190 without meal

\$265 with meal and/or A/V

Capacity:

72 people

meal price not included

Multipurpose Room

**Cost:**

\$150 without A/V

\$250 with A/V

Capacity:

44 people

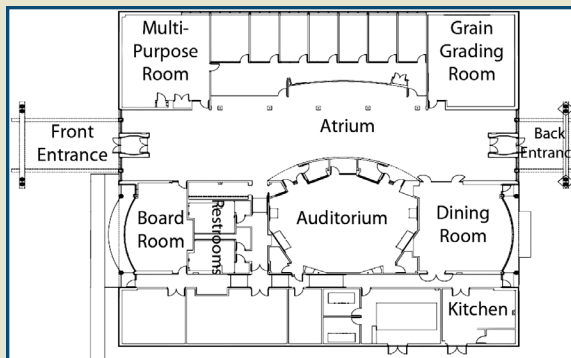

Conference Center Overview

The IGP Conference Center is located on Kimball Avenue and is one of four buildings in the Grain Science and Industry Complex at Kansas State University. The \$4 million building was dedicated in 2004 with the help of three major contributors: the Kansas Wheat Commission, Kansas Corn Commission and Kansas Soybean Commission. The nearly 20,000 square foot building provides world-class meeting areas and instructional facilities.

History

The IGP Institute was established in 1978 at the request of the Kansas wheat, corn, grain sorghum and soybean commissions. The Kansas Legislature provided funds to establish the program and these funds are augmented with funds from Kansas commissions.

The institute is housed in Kansas State University's Department of Grain Science and Industry. It was built upon international training programs the department started conducting in 1961.

Auditorium

**Cost:**

\$300 without A/V

\$550 with A/V

Capacity:

63 people

Board Room

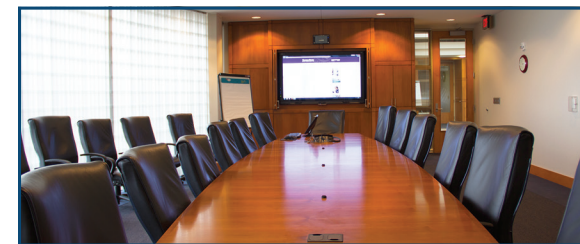
**Cost:**

\$200 without A/V

\$350 with A/V

Capacity:

24 people

Grain Grading Lab

**Cost:**

\$125 without A/V

\$200 with A/V

Capacity:

30 people